



ADJUSTABLE CHOKES



POSITIVE CHOKES

EZ FLOW CONTROL INC.'s Adjustable Choke assemblies and Long Nose Heater Choke assemblies are furnished with Alloy and or Harden Steel Stems and Seats as Standard Trim for Regular or Standard Service. Stainless Steel or Stainless Steel with Tungsten Carbide Trim Sets for Abrasive and or Sour Gas Service are available on request. **Positive Choke** assemblies are furnished *less flow bean*. **Positive choke** assemblies may be converted to **Adjustable Choke** assemblies by replacing the blanking cap assembly and flow bean with the appropriate adjustable bonnet assembly and seat.

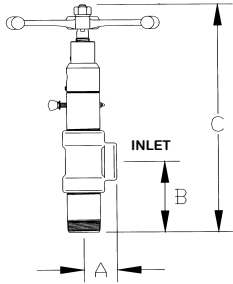

E29

EZ FLOW Model	Inlet	Outlet	Working Pressure	Orifice Size	Dimensions		
					A	B	C
E29	2" FLP	2" MLP	2,000	3/4" & 1"	2.38"	5.31"	16.31"
E30	2" FLP	2" MLP	3,000	3/4" & 1"	2.50	7.44"	22.50"
E263	3" FLP	3" MLP	3,000	2"	4.25	7.50	25.00"

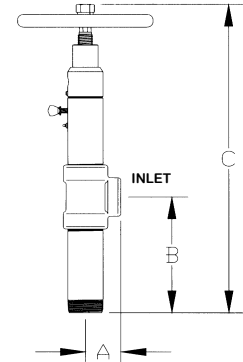

E263

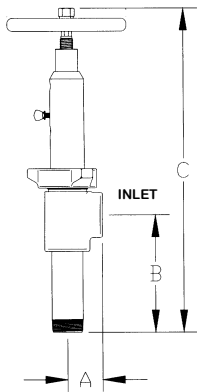

EN60

EZ FLOW Model	Inlet	Outlet	Working Pressure	Orifice Size	Dimensions		
					A	B	C
EN60	2" FLP	2" MLP	5,000	3/4" & 1"	2.75"	9.00	23.50"
EFT108	2" FLP	2" MLP	5,000	1" Max	2.75"	9.00	13.00"

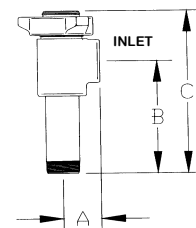

EFT108

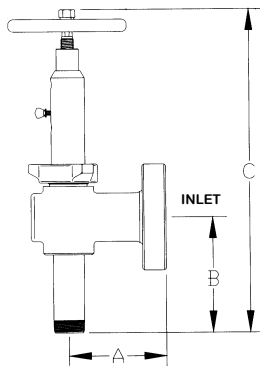

EFT116A

EZ FLOW Model	Inlet	Outlet	Working Pressure	Orifice Size	Dimensions		
					A	B	C
EFT116A	2-1/16 5m	2" MLP	5,000	3/4" & 1"	6.63"	9.00"	23.50"
EFT116P	2-1/16 5m	2" MLP	5,000	1" Max	6.63"	9.00"	13.50"

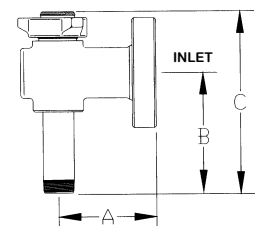

EFT116P

ADJUSTABLE CHOKES



POSITIVE CHOKES

The following Flange Chokes are manufactured in Alloy or Stainless Steel bodies. Standard or Stainless –Steel Tungsten– Carbide trim offered. Standard and H2S configurations available.

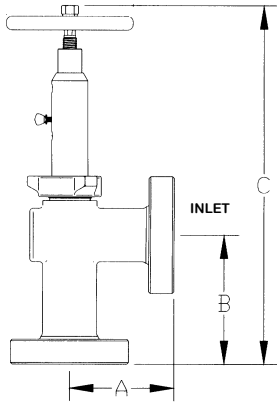

EN62

EZ FLOW Model	Flange Size Inlet & Outlet	Working Pressure	Orifice Size	Dimensions A B C		
EN62 ET1	2-1/16" 2M 2-1/16" 2M	2,000 2,000	3/4" & 1" 1" Max	7.50"	9.38"	24.38"
EN62 ET1	2-1/16" 5M 2-1/16" 5M	5,000 5,000	3/4" & 1" 1" Max	7.50"	9.38"	14.50"
EN62 ET1	150 ANSI RF 150 ANSI RF	275 275	3/4" & 1" 1" Max	7.50"	9.38"	24.38"
EN62 ET1	300 ANSI RF 300 ANSI RF	720 720	3/4" & 1" 1" Max	7.50"	9.38"	14.13"
EN62 ET1	600 ANSI RF 600 ANSI RF	1,440 1,440	3/4" & 1" 1" Max	7.50"	9.38"	14.13"

ANSI R.T.J. available on request

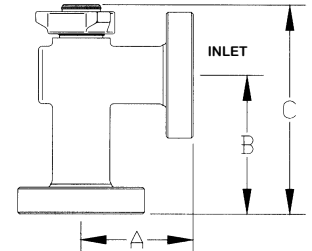

ET1

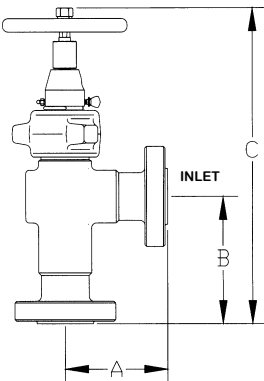

EJWA

EZ FLOW Model	Flange Size Inlet & Outlet	Working Pressure	Orifice Size	Dimensions A B C		
EJWA EPC	2-1/16" 5M 2-1/16" 5M	5,000 5,000	3/4" & 1" 1" Max	7.50"	9.38"	20.81"
EJWA EPC	1-13/16" 10M 1-13/16" 10M	10,000 10,000	3/4" & 1" 1" Max	7.50"	9.19"	21.06"
EJWA EPC	2-1/16" 10M 2-1/16" 10M	10,000 10,000	3/4" & 1" 1" Max	7.50"	9.38"	16.31"
EJWA EPC	1-13/16" 15M 1-13/16" 15M	15,000 15,000	3/4" & 1" 1" Max	7.38"	10.13"	26.06"
EJWA EPC	2-1/16" 15M 2-1/16" 15M	15,000 15,000	3/4" & 1" 1" Max	7.38"	10.13"	18.88"

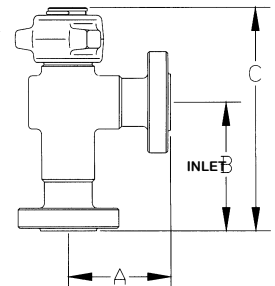

EPC

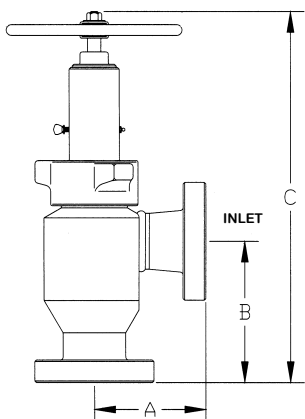

EH2A

EZ FLOW Model	Flange Size Inlet & Outlet	Working Pressure	Orifice Size	Dimensions A B C		
EH2A EH2P	3-1/8" 3M 3-1/8" 3M	3,000 3,000	1", 1-3/4" & 2" 2" Max	8.88"	11.38"	30.00"
EH2A EH2P	2-1/16" 5M 2-1/16" 5M	5,000 5,000	1", 1-3/4" & 2" 2" Max	7.50"	9.38"	18.50"
EH2A EH2P	2-9/16" 5M 2-9/16" 5M	5,000 5,000	1", 1-3/4" & 2" 2" Max	8.88"	11.38"	18.50"
EH2A EH2P	3-1/8" 5M 3-1/8" 5M	5,000 5,000	1", 1-3/4" & 2" 2" Max	8.88"	11.38"	18.50"
EH2A EH2P	2-9/16" 10M 2-9/16" 10M	10,000 10,000	1", 1-3/4" & 2" 2" Max	10.38"	11.75"	30.25"
EH2A EH2P	3-1/16" 10M 3-1/16" 10M	10,000 10,000	1", 1-3/4" & 2" 2" Max	10.38"	11.75"	18.75"

2" Max orifice chokes are also available with 3" ANSI 150 - ANSI 1500 R.F. or R.T.J.

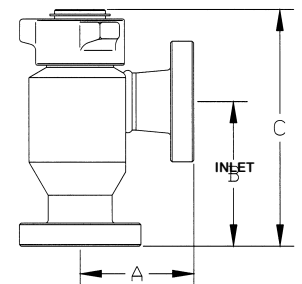

EH2P

TYPICAL PARTS ORDERING INFORMATION

ADJUSTABLE CHOKES

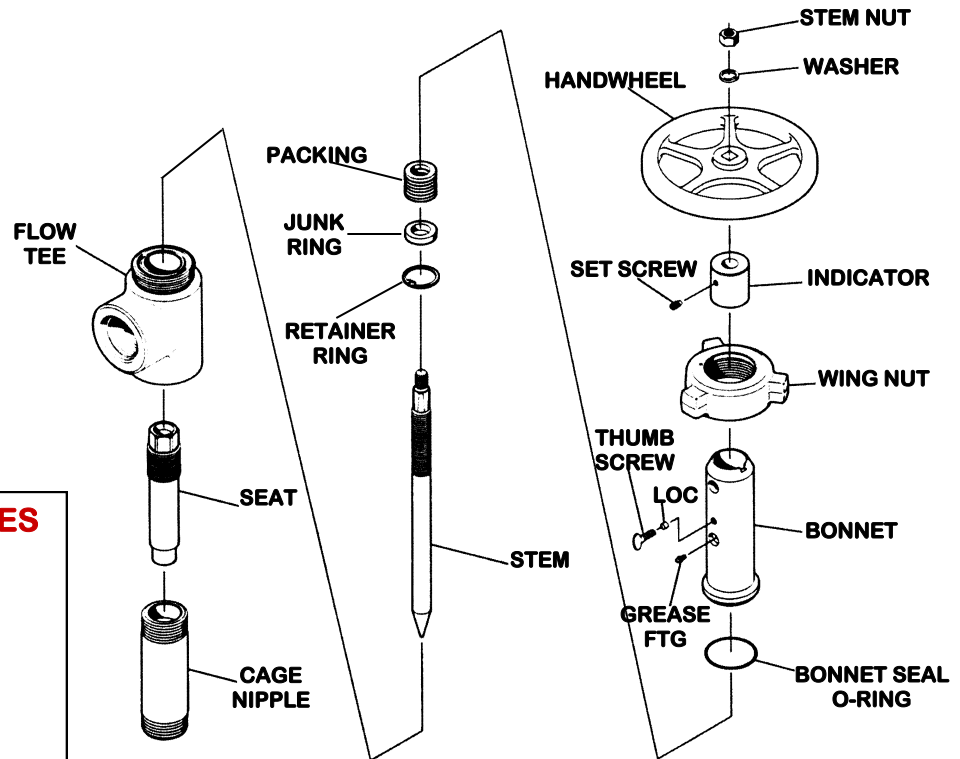

Typical Threaded Adjustable Choke

TIPS TO ORDER CHOKES

1. Type of Choke - "Positive or Adjustable"
2. Specify Working Pressure.
3. Type of Inlet & Outlet Connections, Size and Pressure Rating.
4. Specify Trim Size (Orifice Required)
5. Trim Material - "Alloy Steel, Stainless Steel, Stainless Steel / Tungsten Carbide"
6. Specify Heater Choke if applicable.

Positive Choke assemblies are furnished *less* Flow Bean.

POSITIVE CHOKES

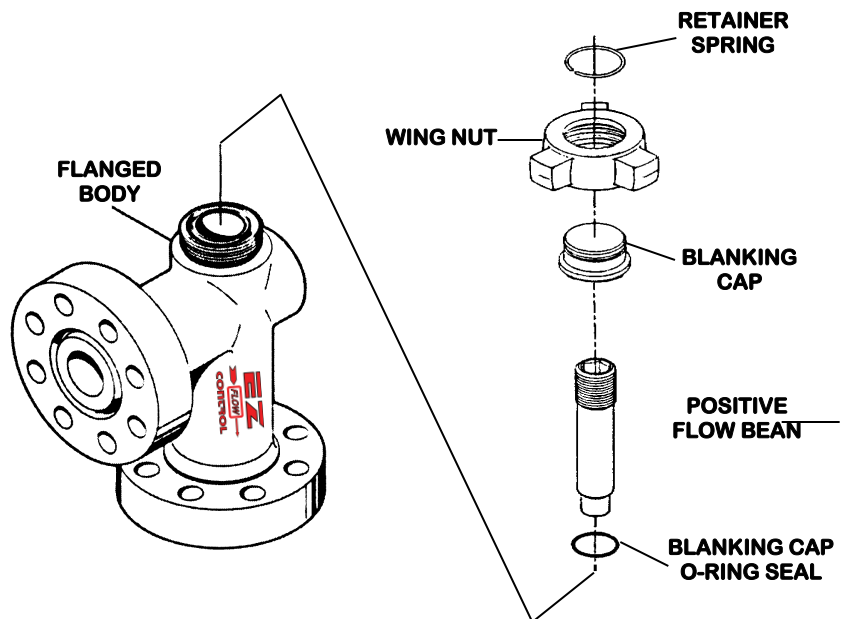

Typical Flanged End Positive Choke



FLOW CONTROL PARTS



CHOKE STEMS & SEATS

TRIM: HARDENED STEEL, STAINLESS-STEEL, STAINLESS STEEL TUNGSTEN-CARBIDE

OIL CENTER TOOL

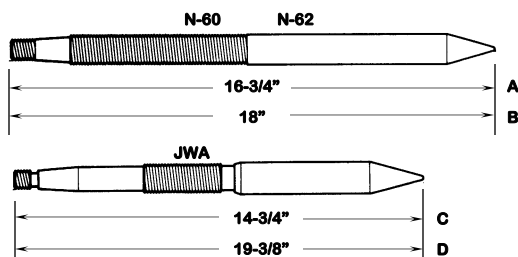

A— 16-3/4"	0-60 / N-60 / FT-116A	E426161 SS/TC
B— 18"	N-62	E426162 SS/TC
C— 14-3/4"	JWA 5m / 10m	E426555 SS/TC
D— 19-3/8"	JWA 15m	E426556 SS/TC

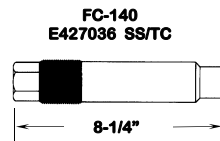

3/4" & 1" ORIFICE

THORNHILL-CRAVER

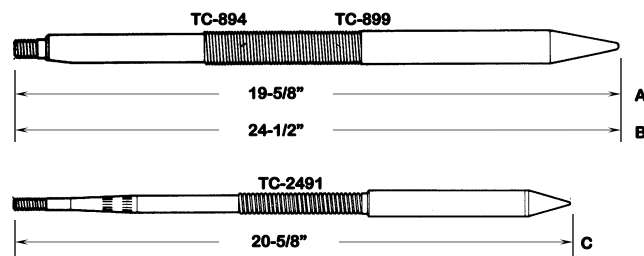

A— 19-5/8"	TC-894 3m / 5m / 10m	E526012 SS/TC
B— 24-1/2"	TC-899 5m / 10m HEATER	E526032 SS/TC
C— 20-5/8"	TC-2491 15m HEATER	E526042 SS/TC

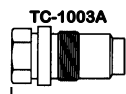

E527018 SS/TC

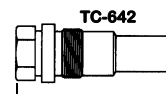

E527039 SS/TC

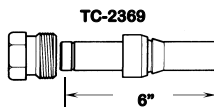

1/2" 3/4" & 1" ORIFICE

CAMERON IRON WORKS

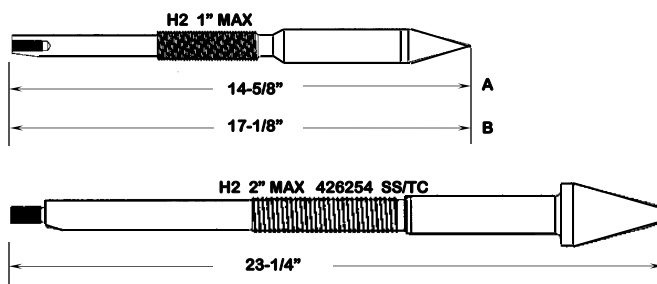

A— 14-5/8"	H2 1" MAX 3m / 5m / 10m	E626144 SS/TC
B— 17-1/8"	H2 1" MAX 15m	E626244 SS/TC

H2 HONEST JOHN 1" MAX
E627165 SS/TC E627166 SS/TC

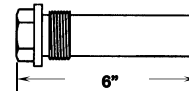
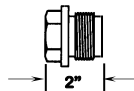

H2 HONEST JOHN 2" MAX
E627254 SS/TC E627264 SS/TC

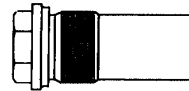
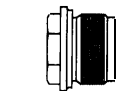

GRAY TOOL COMPANY

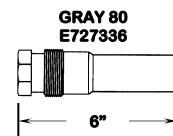
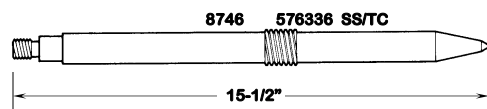

GULFCO

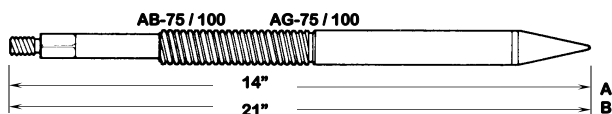

A— 14"	AB-75 & AB-100	826336 SS/TC
B— 21"	AG-75 & AG-100 HEATER	826346 SS/TC

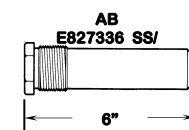
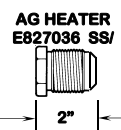

STEMS, SEATS & OTHER TRIM SETS FOR O.E.M.'s ARE AVAILABLE ON REQUEST

ALL DIMENSIONS ARE APPROXIMATE

EZFC's PART # ARE FOR 3/4" SS/TC TRIM UNLESS NOTED

TRIM MATERIAL OFFERED:

**CERAMIC
TUNGSTEN CARBIDE**

6" insert
6" insert

Orifice sizes 4/64" — 48/64
Orifice sizes 4/64" — 128/64"

CHOKE FLOW BEANS available in ALLOY STEEL or STAINLESS STEEL jackets

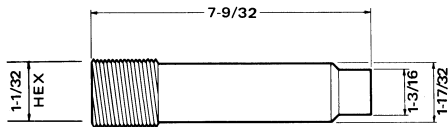

OIL CENTER TOOL

"FC-140"

EZ # E4530xx AS/CER

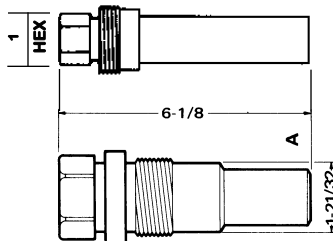

THORNHILL-CRAVER

"TC-1017"

EZ # E5539xx AS/CER

"TC-1003 P"

EZ # E5530xx AS/CER

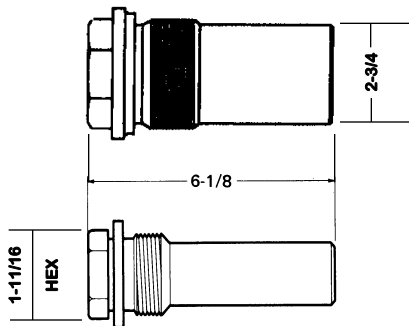

CAMERON IRON WORKS

"BIG JOHN 2" MAX"

EZ # E6532xxx AS/CER

"BIG JOHN 1" MAX"

EZ # E6531xxx AS/CER

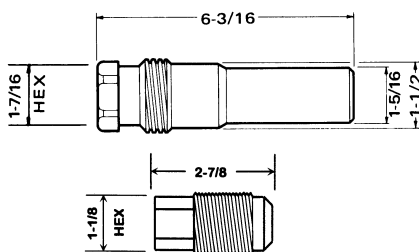

GRAY TOOL COMPANY

"GRAY 80"

EZ # E7530xx AS/CER

"GRAY 40"

EZ # E7534xx AS/CER

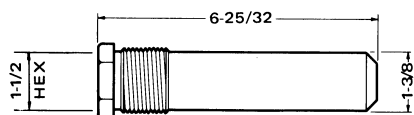

GULFCO

"RB"

EZ # E7630xx AS/CER

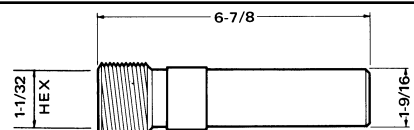

NATIONAL SUPPLY

EZ # E7730xx AS/CER

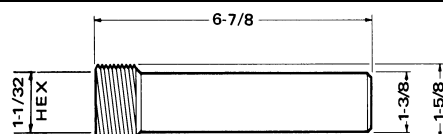

Mc EVOY & HUGH ATLAS

"R"

EZ # E5630xx AS/CER

ALL DIMENSIONS ARE APPROXIMATE

FLOW BEANS

ALLOY STEEL

OIL CENTER TOOL

FC-142 P
 EZ # 4505xx
 20/64" MAX



THORNHILL-CRAVER

TC-575 "X"
 EZ # 5505xx
 14/64" MAX

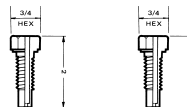

CAMERON IRON WORKS

HONEST JOHN
 EZ # 6505xx
 40/64" MAX



MASTER BEANS

ALLOY STEEL

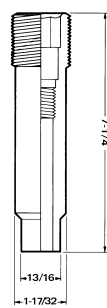

FC-141
 EZ # 450141

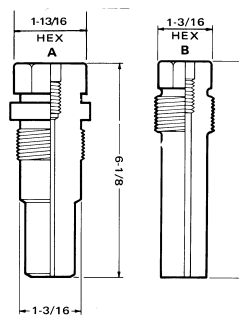

TC-574
 EZ # 550574

TC-573
 EZ # 750573

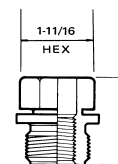

BIG JOHN 1" MAX
 EZ # 650101

FLOW BEAN ADAPTERS

ALLOY STEEL
 STAINLESS STEEL

BJ 2" MAX x BJ 1" MAX
 EZ # E639207

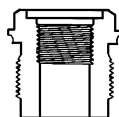

BJ 2" MAX x OCT FC-140
 EZ # E639140

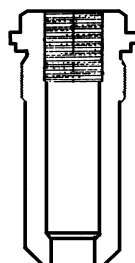

FLOW BEAN WRENCHES

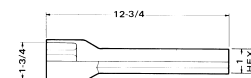

OCT FC-140
 EZ #439012

OCT FC-143
 EZ #439015

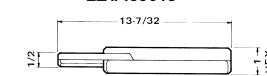

OTHER WRENCHES ALSO AVAILABLE

CAGE NIPPLES

CHOKE NIPPLES

ALLOY STEEL

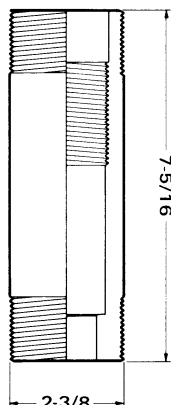

OCT
"FC140"
 EZ # 429011

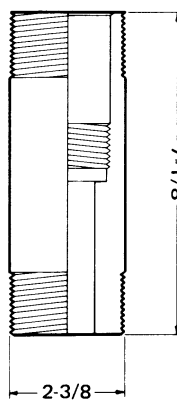

THORNHILL
CRAVER
"TC-1018"
 EZ # 529018

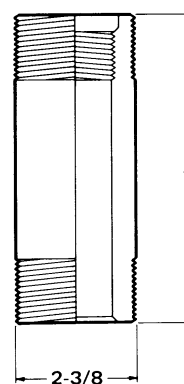

Mc EVOY
"R"
 EZ # 759017

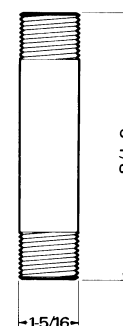

CHOKE NIPPLES
1" x 4" 1" x 6"
2" x 6"

ALL DIMENSIONS ARE APPROXIMATE

LONG NOSE HEATER CHOKES

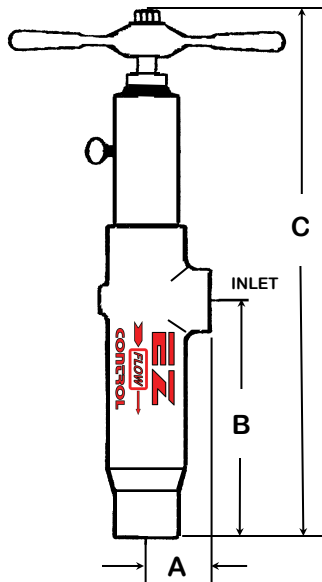

EZ FLOW Model	Inlet	Outlet	Working Pressure	Orifice Size	Dimensions		
					A	B	C
E65LHC E65SHC	2" FLP 2" SW	2" FLP 2" SW	6,500 6,500	1/2", 3/4" & 1" 1/2", 3/4" & 1"	3.25" 3.25"	12.25" 12.25"	28.50" 28.50"
E78LHC E78SHC	2" FLP 2" SW	2" FLP 2" SW	7,800 7,800	1/2", 3/4" & 1" 1/2", 3/4" & 1"	3.25" 3.25"	12.25" 12.25"	28.50" 28.50"
E94BHC	2"XX BW	2"XX BW	9,400	1/2", 3/4" & 1"	5.38"	12.50"	30.00"

EZ FLOW CONTROL'S Long Nose Heater Chokes
Are available for Sour Service

TYPICAL PARTS ORDERING INFORMATION

LONG NOSE HEATER CHOKE

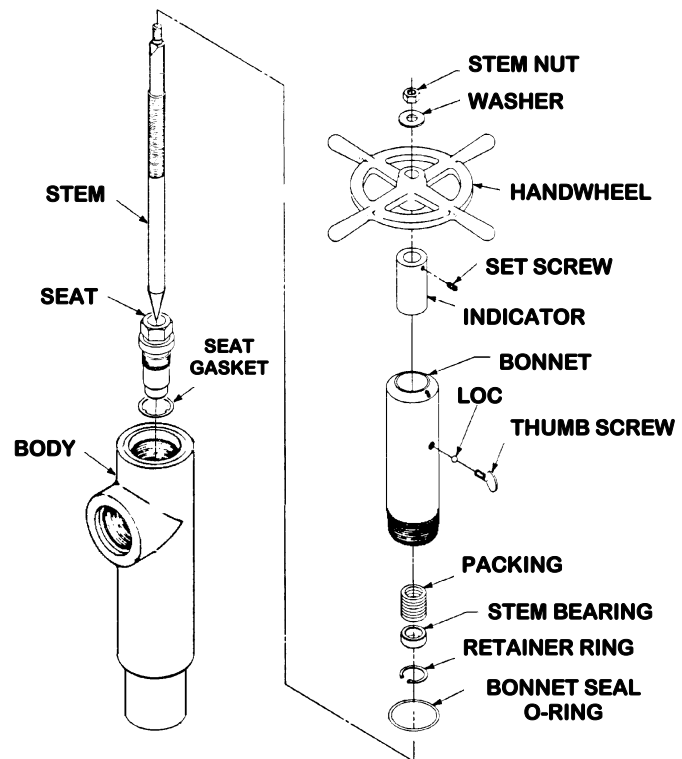

Typical Threaded Long Nose Heater Choke

EZ FLOW CONTROL offers our **"EZ-TALCO"** Adjustable Choke with the following:

**EZ-TALCO
 ADJUSTABLE
 CHOKE
 w/ 2" 1502
 HAMMER UNION
 CONNECTIONS**

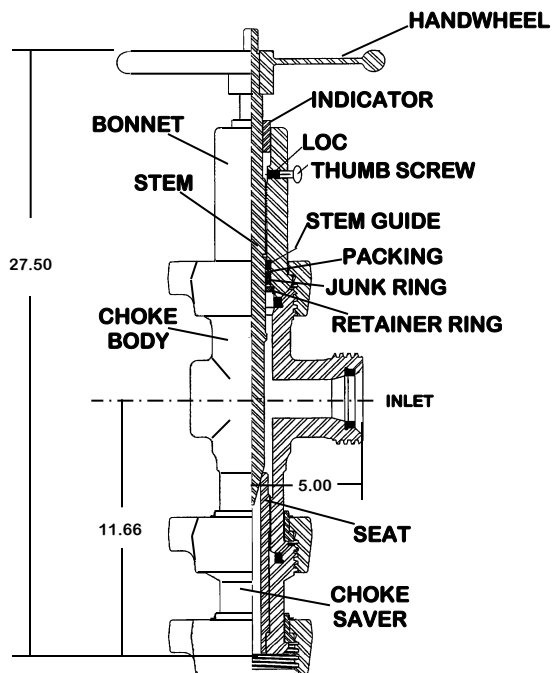

WORKING PRESSURE

10,000 & 15,000 NSCP

END CONNECTIONS

2" Fig 1502 HAMMER UNION
 3" Fig 1502 HAMMER UNION

ORIFICE SIZE

3/4" - 2" MAX SSTC

TRIM MATERIAL

STAINLESS STEEL w/
 TUNGSTEN CARBIDE

EZ-TALCO Adjustable Choke assembly may be converted to a EZ-TALCO Positive Choke assembly by replacing the bonnet assembly and seat with the appropriate blanking cap assembly and flow bean.

**HAMMER UNION
 FITTINGS & ADAPTERS**

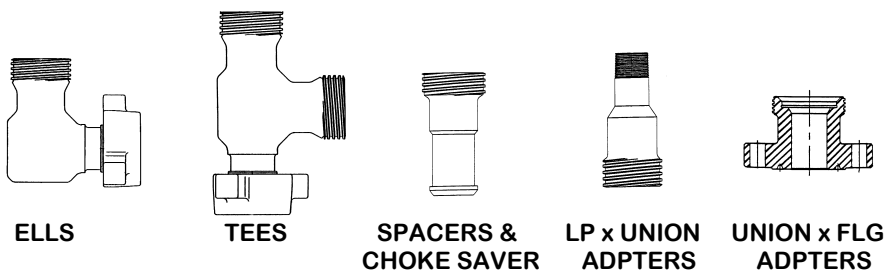

**THREADED
 FITTINGS & ADAPTERS**

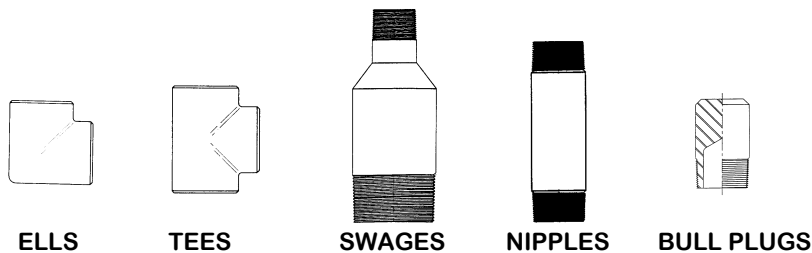

EZ FLOW CONTROL Offers Mud Nipples & Nozzles with the following 1" liners:
 CERAMIC & TUNGSTEN CARBIDE
 Stock 1/4", 3/8", 1/2", 5/8", & 3/4"

**MUD GUN
 NOZZLES**

ALLOY
 STAINLESS STEEL

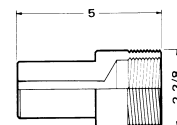
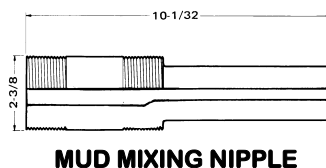

EZ FLOW CONTROL INC.

“STANDARD TERMS and CONDITIONS”

QUOTATIONS: All quotations, prices, and sales are F.O.B. factory unless otherwise expressly stated in writing. Quotations are for immediate acceptance unless a definite period of time is stated within which acceptance may be made. All prices and discounts, now ineffect, or hereafter issued, are subject to change without notice. Requests for quotations on products for export should be sent directly to **EZ LOW CONTROL, INC.**, P.O. BOX 40656, AUSTIN, TEXAS 78704 USA. Unless otherwise agreed in writing, litherage, wharfage of lading fees, duties, or any other charges at destination are not included in quotations. Counselor’s fees for legalizing invoices, stamping bills of lading, import duty, or other documents required by the laws of any country of destination, are not included in quotation or selling prices. Upon proper written instructions, **EZ FLOW** will attempt to arrange for Consular documents and declaration, as agents of the customer, but **EZ FLOW** assumes no responsibility for any damages, liability, fines, or charges imposed due to errors or incorrect declarations.

GUARANTEE: Products of **EZ FLOW** are guaranteed against defects of material and workmanship for one year from date of invoice, provided such products are used normally and within the service and pressure range for which they were manufactured. Claims for a breach of this guarantee shall be limited to replacement, free of charge, of any part or product that proves to be defective in material or workmanship, as deemed by **EZ FLOW**, upon written notice of such defect given in thirty (30) days and return of such item to **EZ FLOW**. Costs of labor, freight, drayage, or other similar charges shall be at the customer’s expense. This warranty is limited in extent to the warranty, if any, which the user receives from the manufacturers of any component parts.

ALL OTHER WARRANTIES OR LIABILITIES EXPRESSED, IMPLIED, ORAL OR STATUTORY, INCLUDING ANY WARRANTY OF MERCHANTABILITY OR FITNESS FOR A PARTICULAR PURPOSE ARE EXPRESSLY DENIED. In no event shall the company, its agents or employees be liable for injury or damage to any person or property whatsoever or for any special, indirect, secondary, or consequential damage of any nature however arising.

PACKING: **EZ FLOW** endeavors to pack or prepare all shipments so that they will not break, rust, or deteriorate in transit, but does not guarantee against damage. All claims regarding shortages must be made in writing within ten (10) days from receipt of shipment and must be accompanied by the packing list. Shipments may be insured by the customer against damage or loss in transit upon written request, but in such cases **EZ FLOW** acts only as an agent without recourse between the insurance company and the customer and assumes no liability whatsoever.

DELIVERY: Delivery date estimate are made as accurately as possible and every effort will be made to meet such delivery target, but **EZ FLOW** will assume no further or implied liability for damages arising from failure to deliver material within the time specified. **EZ FLOW**’s responsibility for risk of loss or damage in transit ceases on delivery any common carrier.

CANCELLATIONS: Orders once placed and accepted can be cancelled only with the consent of and upon terms acceptable to **EZ FLOW**. Deposits or prepayments shall be considered liquidated damages at the option of **EZ FLOW**, which shall not, however, be limited to such remedies for any breach or cancellation of an order.

RETURN OF MATERIAL: Merchandise may be returned for credit or adjustment only with **EZ FLOW**’s written permission. Items manufactured of special design, size, or material will not be accepted for credit, however, nor will cancellation of such orders be accepted, without full compensation to **EZ FLOW** for all expenses incurred after such orders are in production. Products classified by **EZ FLOW**, as special design or those not conforming to our standard line, are not accepted for credit. Merchandise approved for return will be subject to our inspection and to a charge for reconditioning and restocking, and merchandise credit only will be issued based on the net purchased invoice price less freight charges.

TERMS OF PAYMENT: Unless otherwise specified, all invoices are due net thirty (30) days from date of invoice. No orders shall be considered as accepted by the company until approved through **EZ FLOW**’s office.

FREIGHT CHARGES AND ALLOWANCES: All freight is shipped FOB **EZ FLOW** Facility unless agreed upon in writing by **EZ FLOW** and customer.

CHANGE OF DESIGN: **EZ FLOW** reserves the right to change or modify the design or construction of any product or the manufacturing process thereof produced by **EZ FLOW** without notice to customer and without any obligation to furnish or install such changes or modifications on products previously or subsequently sold.

TAXES: The purchaser shall pay any tax or other charge imposed by law on the sale or production of goods.

